

AD-A262 970



NOTATION PAGE

Form Approved
GSA GEN. REG. NO. 27

1

1. AGENCY USE ONLY (Leave blank)		2. REPORT DATE AUGUST 1983	3. REPORT TYPE AND DATES COVERED final
4. TITLE AND SUBTITLE A Cultural Resources Survey of the Yazoo-Mississippi Delta Levee Slide Repair DeSoto Co.,MS A Negative Finding			5. FUNDING NUMBERS 96X312
6. AUTHOR(S) Jimmy D. McNeil			8. PERFORMING ORGANIZATION REPORT NUMBER
7. PERFORMING ORGANIZATION NAME(S) AND ADDRESS(ES) in house			
9. SPONSORING MONITORING AGENCY NAME(S) AND ADDRESS(ES) Dept. of the Army Memphis District Corps of Engineers B-202 Clifford Davis Federal Bldg. Memphis, TN 38103			10. SPONSORING MONITORING AGENCY REPORT NUMBER 158
11. SUPPLEMENTARY NOTES			
12a. DISTRIBUTION AVAILABILITY STATEMENT Unlimited			12b. DISTRIBUTION CODE
13. ABSTRACT (Maximum 200 words) A pedestrian survey and literature search failed to locate any prehistoric, historic, or architectural sites within the project right-of-way.			
14. SUBJECT TERMS			15. NUMBER OF PAGES 5
			16. PRICE CODE
17. SECURITY CLASSIFICATION OF REPORT	18. SECURITY CLASSIFICATION OF THIS PAGE	19. SECURITY CLASSIFICATION OF ABSTRACT	20. LIMITATION OF ABSTRACT

DTIC
ELECTE
APR 20 1993
S C D

93-08118

93-08118



12PX

A Cultural Resources Survey of the
Yazoo-Mississippi Delta Levee Slide Repair
DeSoto County, Mississippi
A Negative Finding Report

U. S. Army Corps of Engineers
Memphis District

Jimmy McNeil

DTIC QUALITY INSPECTED 4

August 1983

Accession For	
NTIS CRA&I	<input checked="" type="checkbox"/>
DTIC TAB	<input type="checkbox"/>
Unannounced	<input type="checkbox"/>
Justification	
By	
Distribution /	
Availability Codes	
Dist	Avail and/or Special
A-1	

Abstract

On 28 July, 1983, an intensive survey of a proposed borrow area near Walls, Mississippi was conducted by the Environmental Branch of the U. S. Army Corps of Engineers; Memphis District Staff Archeologist, Mr. Jimmy McNeil and Ms. Joan Koch, conducted the survey.

The project is located in Township 1S, Range 9W, Section 28 NW 1/4 of the SW 1/4 of the Horn Lake, Mississippi-Tennessee-Arkansas Quadrangle map, DeSoto County, Mississippi.

The proposed work includes removal of fill materials from a designated borrow area, and placing the fill in levee slides. All fill materials will be transported over existing roads.

A pedestrian survey of portions of the borrow area failed to locate any prehistoric, historic, or architectural sites within the project right-of-way.

TABLE OF CONTENTS

Abstract	1
Table of Contents	11
Introduction	1
Project Description	1
Environmental Setting	1
Previous Research	2
Results of the Records Search	3
Survey Methodology and Results	3
Recommendations	3
References Cited	5
Map 1	General View of the Project Area
Photo 1	Aerial Photo of the Project Area

Introduction

An intensive survey for cultural resources was conducted by Memphis District archeologists on 28 July 1983, within the proposed project right-of-way of the Yazoo-Mississippi Delta Levee as directed by the U. S. Army Corps of Engineers, Memphis District. This study was performed as required by the National Environmental Policy Act of 1968 (Public Law 91-190), Protection and Enhancement of Cultural Historic and Cultural Properties (36 CFR 800), and the National Historic Preservation Act of 1966 (Public Law 898-665).

Project Description

The permit area is located in DeSoto County, Mississippi, Township 1S, Range 9W, Section 28 NW 1/4 of SW 1/4 of the Horn Lake Mississippi-Tennessee-Arkansas Quadrangle; adjacent to Horn Lake. Four small slide areas on the levee require repairs. An area, approximately 3.4 acres in size, has been designated for borrow. The borrow area is at the southern end of an existing borrow area. The borrow materials will be placed in the levee slide areas. All materials will be transported over existing roads. The attached map (Map 1) and aerial photograph (Photo 1) depict the location of the project.

Environmental Setting

This area is located within the Humid Continental Climate zone, which is noted for its hot summers and mild winters. Average annual precipitation is 49.7 inches (126 centimeters) of which approximately 10% is snowfall

(Commonwealth 1981).

Located about 7 miles southeast of the Mississippi River. The basic geologic history is of recent build-up. The uplands are capped with loess in thicknesses ranging from 3-30.5 meters. However, the floodplains are filled with up to 9 meters of recent alluvium.

Most of the area surrounding Horn Lake is in cultivation. Some trees and swampy areas remain near ditches and the levee. Most of these trees fall into the oak-hickory, elm-ash and gum-cottonwood-cypress categories (COE 1973:10).

Fauna of the region includes deer, raccoon, opossum, squirrel and various birds and reptiles (COE 1975).

Previous Research

The major research conducted in the area of this survey was performed by Phillips, Ford and Griffin (1951). Later, 1949-1955, Phillips (1970) surveyed the Lower Yazoo River Basin. The Walls Site (Walls phase type site) was first described by Brown (1926) and later tested by Phillips, Ford and Griffin (1951). The Walls site is located approximately 4 miles west of this project.

The Nonconnah Creek Basin (next drainage north of Horn Lake) has been unsystematically surveyed by Dr. Gerald Smith (1971) since the early 1960's. A reconnaissance type survey was conducted by Gilbert/Commonwealth Associates

(1981) of the Memphis Metropolitan Area. Their reconnaissance included the Horn Lake Creek area.

Results of the Records Search

A search of the Mississippi Records File was not conducted because (1) of the areas small size; (2) the fact that the area has been previously disturbed, and (3) a literature and records search was conducted by Gilbert/Commonwealth in 1980. However, the National Register of Historic Places was consulted and no sites were listed within the project area.

Survey Methodology and Results

The survey conducted on 28 July 1983, consisted of walking over the area available for borrow. This area has been plowed and rained on, thus it had excellent visibility. No artifacts, stains, or other cultural resource indicators were found in the borrow area. The previously borrowed areas were under water.

Recommendations

As no cultural remains or indicators were found within the borrow area; and all non-borrow work and transportation will be conducted on the levee and existing roads, it is recommended that construction be allowed to proceed as planned.

The survey methodology used does not eliminate the possibility of encountering deeply buried sites. Therefore, it is recommended that any site encountered during construction be protected from further damage by stopping construction until its significance can be determined by the Environmental Resource Branch, Memphis District, U. S. Corps of Engineers in conjunction with the Office of Mississippi Division of Historic Preservation.

References Cited

- Brown, Calvin S.
1926 Archeology of Mississippi. Mississippi Geological Survey,
University of Mississippi.
- Commonwealth Associates, Inc.
1981 Study of Archeological, Architectural and Historical
Resources within the Memphis Metropolitan Area; Tennessee,
Arkansas and Mississippi: Horn Lake Creek Area.
- Corps of Engineers
1973 Interim Report on Nonconnah Creek, Tennessee and
Mississippi. Memphis District, U. S. Army Corps of
Engineers, Memphis, Tennessee.
- 1975 Final Environmental Statement Nonconnah Creek, Tennessee and
Mississippi. Memphis District, U. S. Army Corps of
Engineers, Memphis, Tennessee.
- Phillips, Philip
1970 Archeological Survey in the Lower Yazoo Basin, Mississippi,
1949-1955. Papers of the Peabody Museum, Harvard
University, Vol. 60, Cambridge.
- Phillips, Philip, James A. Ford and James B. Griffin
1951 Archeological Survey in the Lower Mississippi Alluvial
Valley, 1940-1947. Papers of the Peabody Museum of
Archeology and Ethnology, Vol. 25, Cambridge.
- Smith, Gerald P.
1979 Ceramic Handle Styles and Cultural Variations in the
Northern Sector of the Mississippi Alluvial Valley. Memphis
State University Anthropological Research Center Occasional
Papers, No. 3, Memphis, Tennessee.

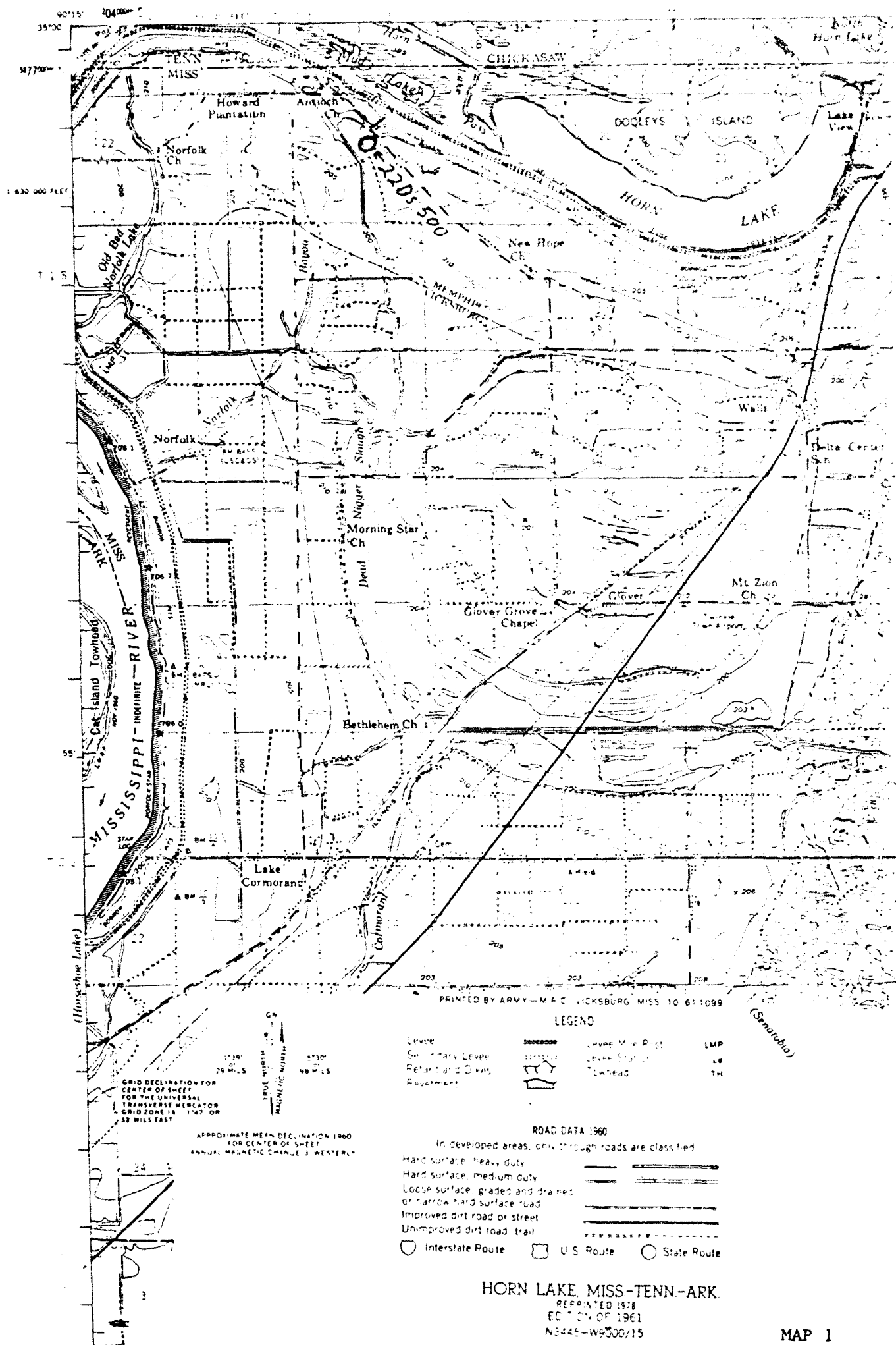

PRINTED BY ARMY—M.A.C. VICKSBURG, MISS. 10 61 1099

LEGEND

- Levee
- Secondary Levee
- Retention Dams
- Revetment
- Levee Main Post
- Levee Station
- Towhead
- LMP
- LB
- TH

ROAD DATA 1960

- In developed areas, only through roads are classified
- Hard surface, heavy duty
 - Hard surface, medium duty
 - Loose surface, graded and drained
 - or narrow hard surface road
 - Improved dirt road or street
 - Unimproved dirt road, trail
 - Interstate Route
 - U.S. Route
 - State Route

GRID DECLINATION FOR CENTER OF SHEET FOR THE UNIVERSAL TRANSVERSE MERCATOR GRID ZONE 18 1747 OR 32 MILES EAST

APPROXIMATE MEAN DECLINATION 1960 FOR CENTER OF SHEET ANNUAL MAGNETIC CHANGE 2 WESTERLY

TRUE NORTH
MAGNETIC NORTH

HORN LAKE, MISS- TENN-ARK.
 REPRINTED 1978
 ED. 24 OF 1961
 N3445-W9300/15

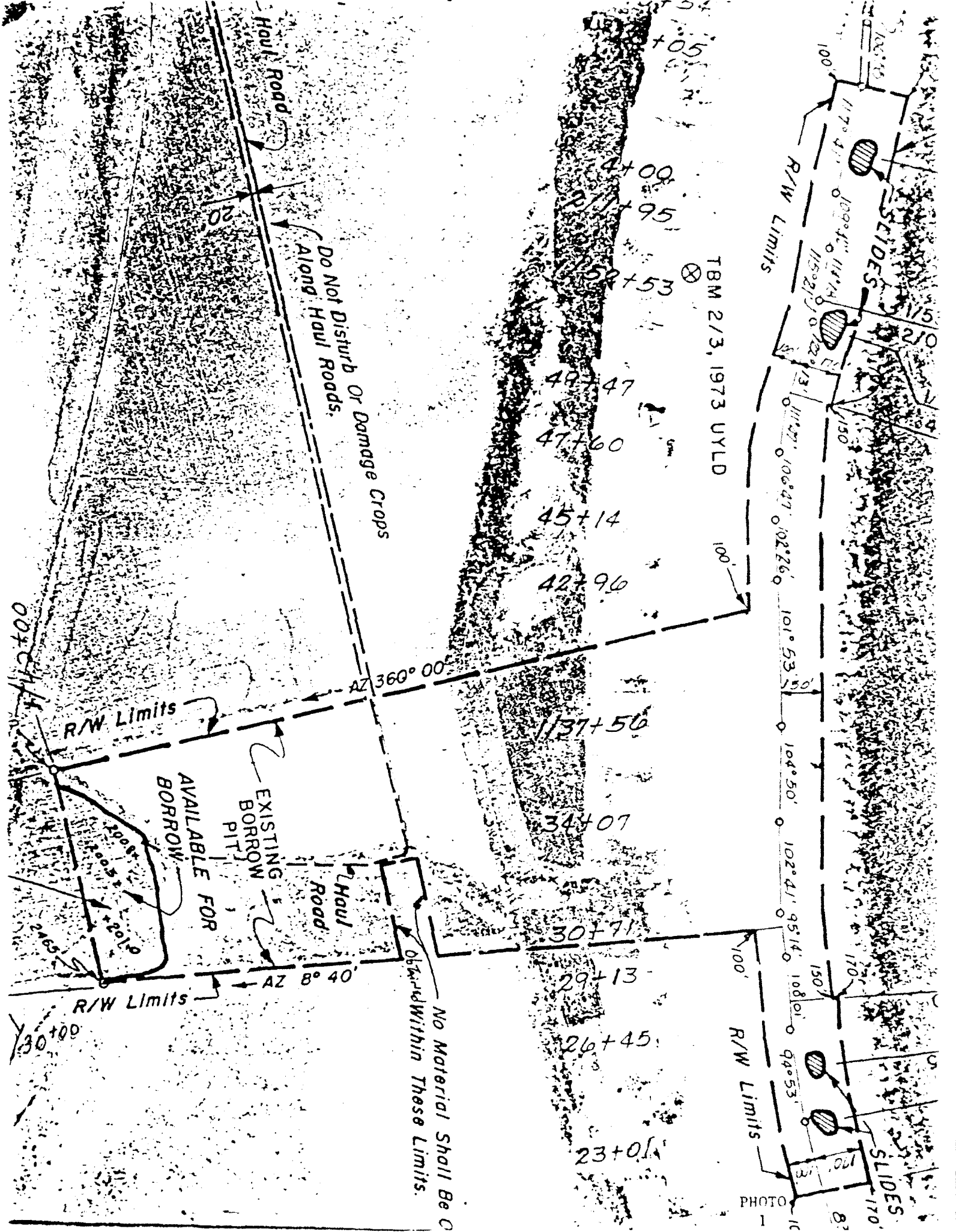

Haul Road

20'

Do Not Disturb Or Damage Crops Along Haul Roads.

R/W Limits

SLIDES

TBM 2/3, 1973 UYLD

⊗

44+00
41+95
52+53

49+47

47+60

45+14

42+96

AZ 360° 00'

R/W Limits

AVAILABLE FOR BORROW
EXISTING BORROW PIT

Haul Road

37+50

34+07

30+71

29+13

26+45

23+00

100'

101° 53'

104° 50'

102° 41' 95" 14'

108° 01'

94° 53'

170'

PHOTO 1

R/W Limits

SLIDES

No Material Shall Be Obtained Within These Limits.

00+00

30+00